

WEST SUSSEX COUNTY COUNCIL  
((CRAWLEY BOROUGH) (PARKING PLACES AND TRAFFIC REGULATION)  
(CONSOLIDATION) ORDER 2010)  
(THE PARADE AMENDMENT) ORDER 2015

CRAWLEY: LOCATION OF WAITING RESTRICTIONS

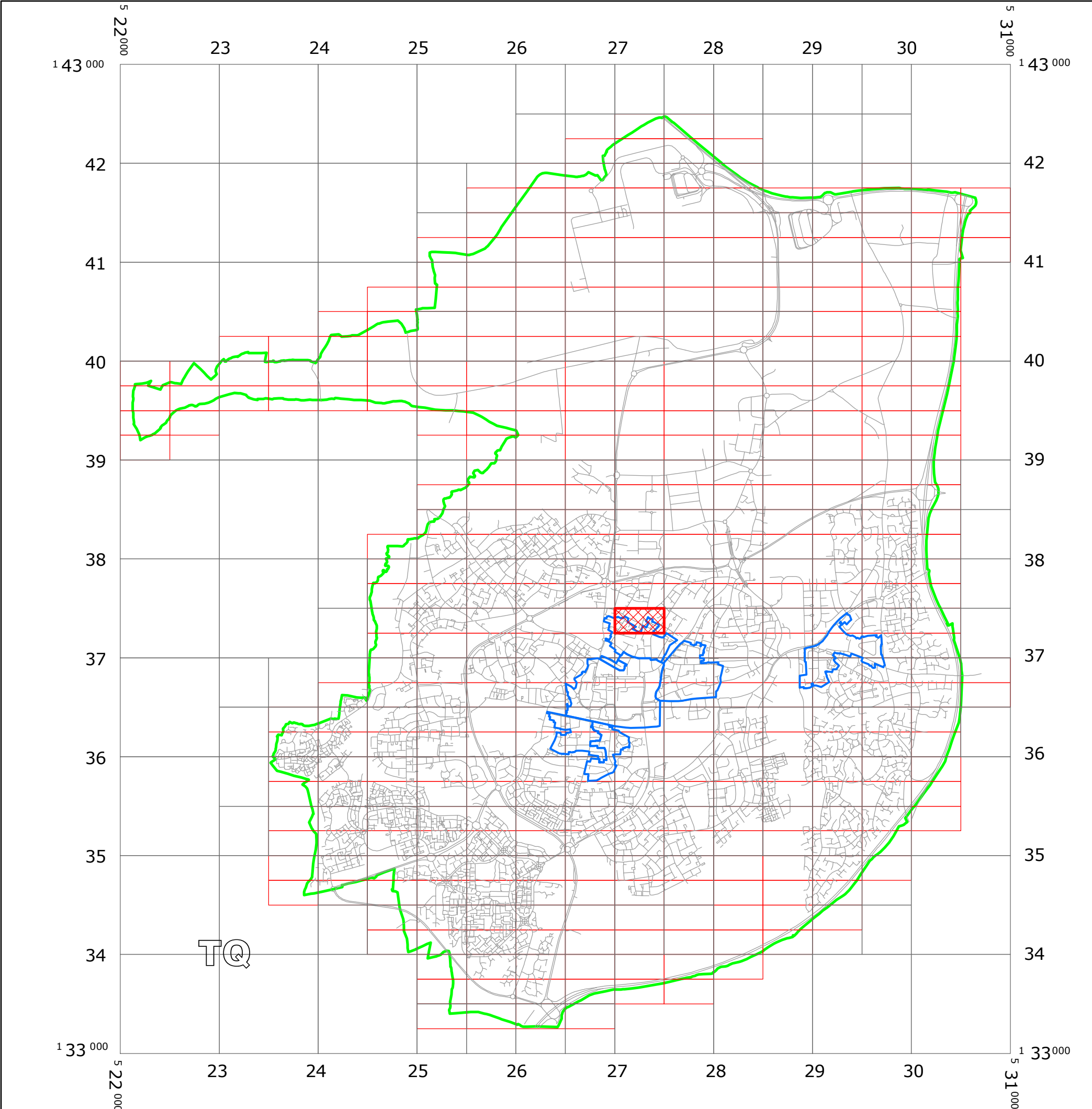

KEY:

OS TILE GRID

PARKING TILE GRID

West Sussex County Council  
Communities & Infrastructure  
The Grange  
Tower Street  
Chichester  
West Sussex  
PO19 1RH

WEST SUSSEX COUNTY COUNCIL  
((CRAWLEY BOROUGH) (PARKING PLACES AND TRAFFIC REGULATION)  
(CONSOLIDATION) ORDER 2010)  
(THE PARADE AMENDMENT) ORDER 2015

LOCATION OF WAITING RESTRICTIONS

Reproduced from or based upon 2013 Ordnance Survey material with permission of the Controller of HMSO  
(c) Crown Copyright reserved. Unauthorised reproduction infringes Crown copyright and may lead to  
prosecution or civil proceedings West Sussex County Council Licence No. 100023447

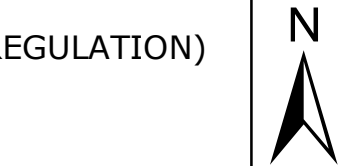



SCALE: 1:40,000  
DATE: 18/05/2015

Key for Waiting Restrictions

All areas over which the provision of the orders apply are defined by the shaded areas as shown on the following plans plus a contiguous area not indicated on the plans of verge and/or footway between the carriageway edge and the highway boundary. The plans in this schedule are based upon grid references of the Ordnance Survey National Grid defined by the OSGB 36 triangulation.

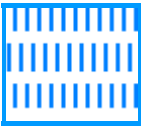
Prohibition of waiting at any time

101		check	No waiting at any time			
158		pat 046	No waiting 9.00am-5.00pm Mon-Sat except bank holidays	171		circle4 No waiting 8.00am-10.00am Mon-Sat except bank holidays

Residents Parking

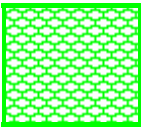
512		usgs503	Residents' and Visitors' permit holders only 9.00am-5.00pm Mon-Sat except bank holidays
-----	---	---------	--

Clearways

1100		usgs503	School Keep Clear-No stopping at any time	1104		usgs620 Bus stop clearway 7.00am-7.00pm any day
------	---	---------	---	------	---	--

 Boundary of Controlled Parking Zone

**WEST SUSSEX COUNTY COUNCIL**  
**((CRAWLEY BOROUGH) (PARKING PLACES AND TRAFFIC REGULATION)**  
**(CONSOLIDATION) ORDER 2010)**  
**(THE PARADE AMENDMENT) ORDER 2015**

West Sussex County Council in exercise of their powers under Sections 1 (1) 2 (1) and (2), 4 (2), 45, 46, 49 and 53 and Part IV of Schedule 9 of the Road Traffic Regulation Act 1984 "the Act" as amended and of all other enabling powers and after consultation with the chief officer of police in accordance with Part III of Schedule 9 to the Act hereby make the following Order:-

1. This Order shall come into operation on the 18<sup>th</sup> day of May 2015 and may be cited as "West Sussex County Council ((Crawley Borough) (Parking Places and Traffic Regulation) (Consolidation) Order 2010) (The Parade Amendment) Order 2015."
2. The "West Sussex County Council (Crawley Borough) (Parking Places and Traffic Regulation) (Consolidation) Order 2010" is hereby amended by the deletion from it of the plan specified in the First Schedule to this Order and the substitution of the plan attached in the Second Schedule to this Order.

**FIRST SCHEDULE**  
**Plan to be deleted**

TQ2737SWN (Sheet No. 4)

**SECOND SCHEDULE**  
**Plan to be substituted**  
**(as attached)**

TQ2737SWN (Sheet No. 5)

THE COMMON SEAL of WEST SUSSEX  
COUNTY COUNCIL was hereto affixed

the Twelfth day of May 2015  
in the presence of:

M Kendall

Authorised Signatory

)  
)  
)  
)  
) (L.S.)  
)  
)  
)  
)

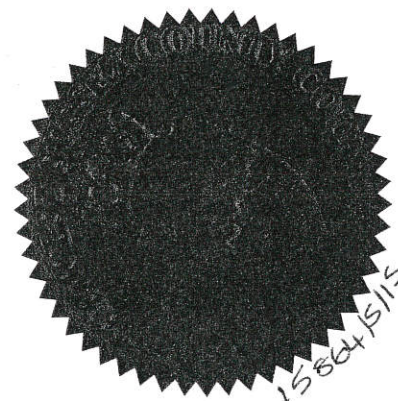

I HEREBY CERTIFY THIS TO  
BE A TRUE COPY OF THE  
ORIGINAL DOCUMENT

Tom Kenward

Authorised Officer

WEST SUSSEX COUNTY COUNCIL

cy/cx DELEGATED AUTHORITY



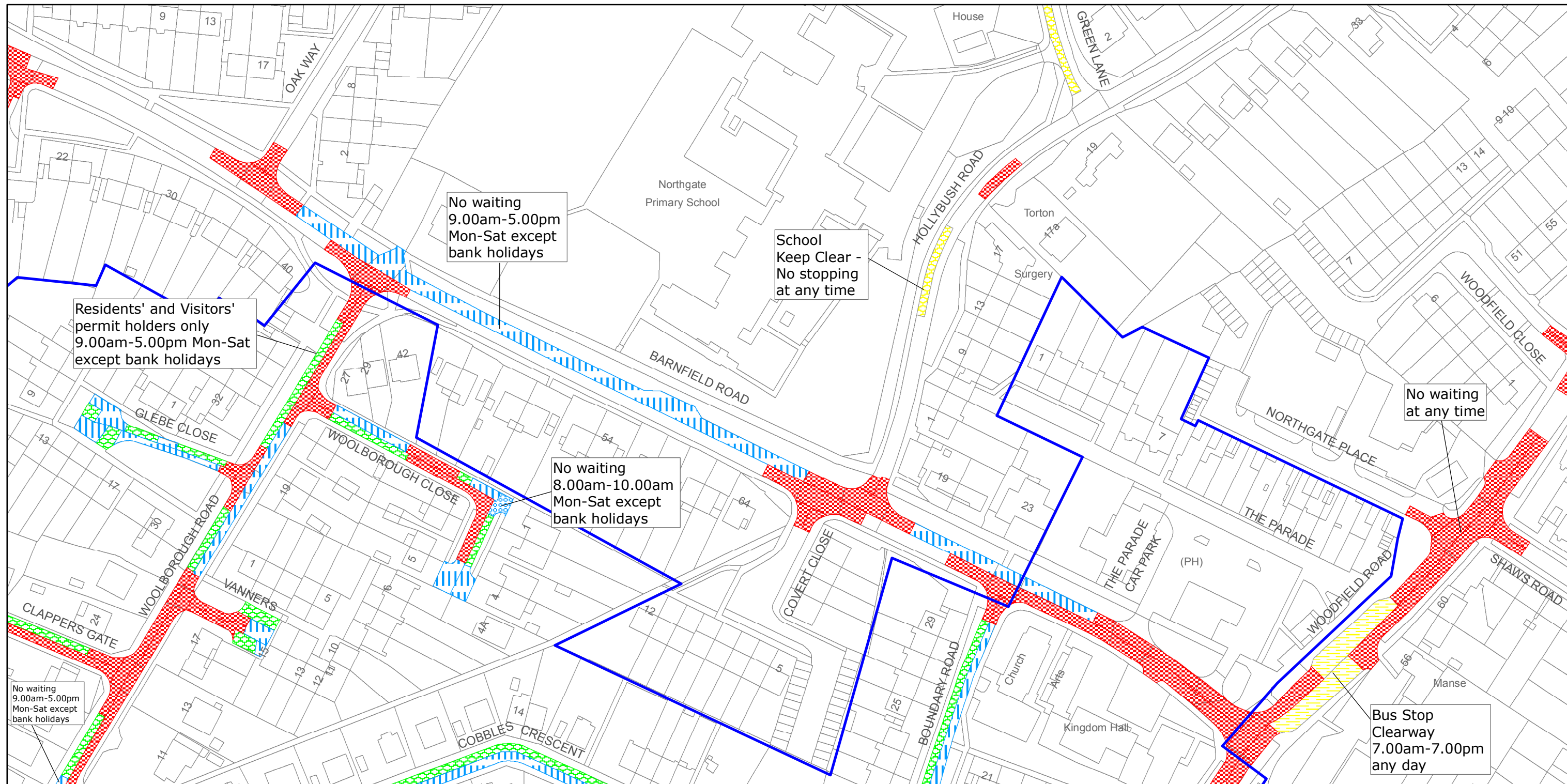

West Sussex County Council  
Highways & Transport  
The Grange  
Tower Street  
Chichester  
West Sussex  
PO19 1RH

## CRAWLEY BOROUGH: NORTHGATE AND WEST GREEN WARDS

### WAITING RESTRICTIONS

Reproduced from or based upon 2013 Ordnance Survey material with permission of the Controller of HMSO (c) Crown Copyright reserved.  
Unauthorised reproduction infringes Crown copyright and may lead to prosecution or civil proceedings West Sussex County Council Licence No. 100023447

**TILE REF NO:  
TQ2737SWN**

SHEET ISSUE NO 6

SHEET ACTIVE FROM - 18/05/2015



SCALE:  
1:1250  
at A3 size